

# REPUBLIC

- 15. HANDLE LATCH
  - A. HANDLE—Cat. No. 2580
  - B. SPRING—Cat. No. 2565
  - C. WASHER—Cat. No. 2570
  - D. STUD—Cat. No. 2575
  - E. BUMPER—Cat. No. 2560
  - F. BRACKET—Cat. No. 2555
- 16. SPRING LATCH FOR HEAVY DUTY LOCKER—Cat. No. 2175
- 17. DOOR STOP—Cat. No. 2700
- 18. DOOR STOP—Cat. No. 2703
- 19. DOOR STOP—Cat. No. 2715
- 20. WIRE BASKET, PADLOCK ATTACHMENT—Cat. No. 2709
- 21. HINGE—Cat. No. 2706
- 22. NEW STYLE SPRING LATCH Cat. No. 2758
- 23. LATCH FINGER BUMPER Cat. No. 2781
- 24. LATCH FINGER—Cat. No. 2770
- 25. LATCH FINGER SPRING Cat. No. 2775
- 26. TUBE RIVET—Cat. No. 2759
- 27. RETAINING BUTTON Cat. No. 4630
- 28. DOOR KNOB (screw included) Cat. No. 2985
- 29. DOUBLE PRONG HOOK Cat. No. 2950
- 30. DOUBLE PRONG HOOK Cat. No. 2960
- 31. WALL HOOK—Cat. No. 2955
- 32. STUD—Cat. No. 2417
- 33. TOP SPRING—Cat. No. 2413
- 34. TOP CAM—Cat. No. 2410
- 35. BOTTOM SPRING Cat. No. 2408
- 36. BOTTOM CAM—Cat. No. 2405
- 37. DOUBLE DOOR BUMPER Cat. No. 2412

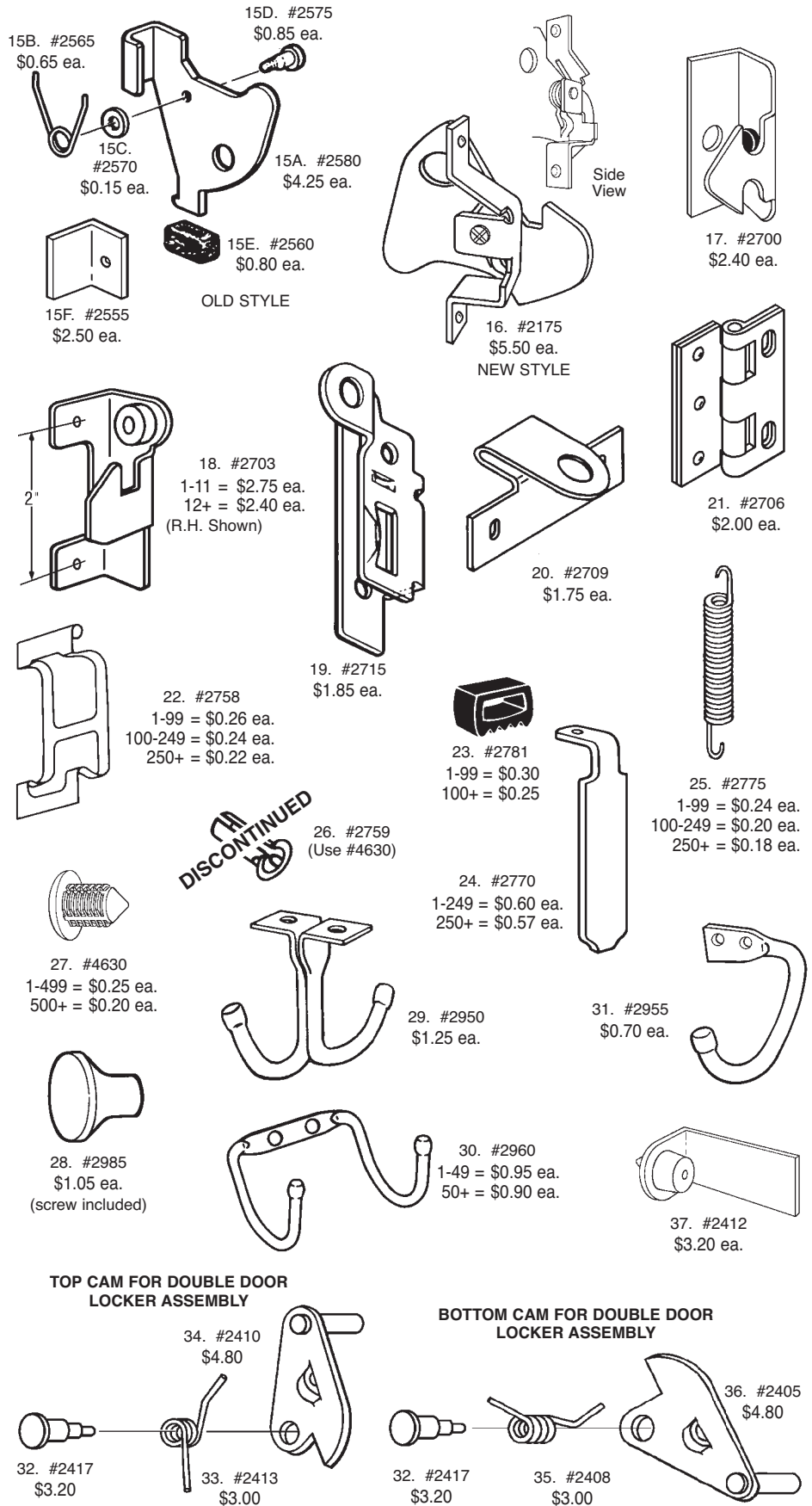

**Graffiti Remover**  
 See page 39