

# DOOR HOLDERS & STOPS

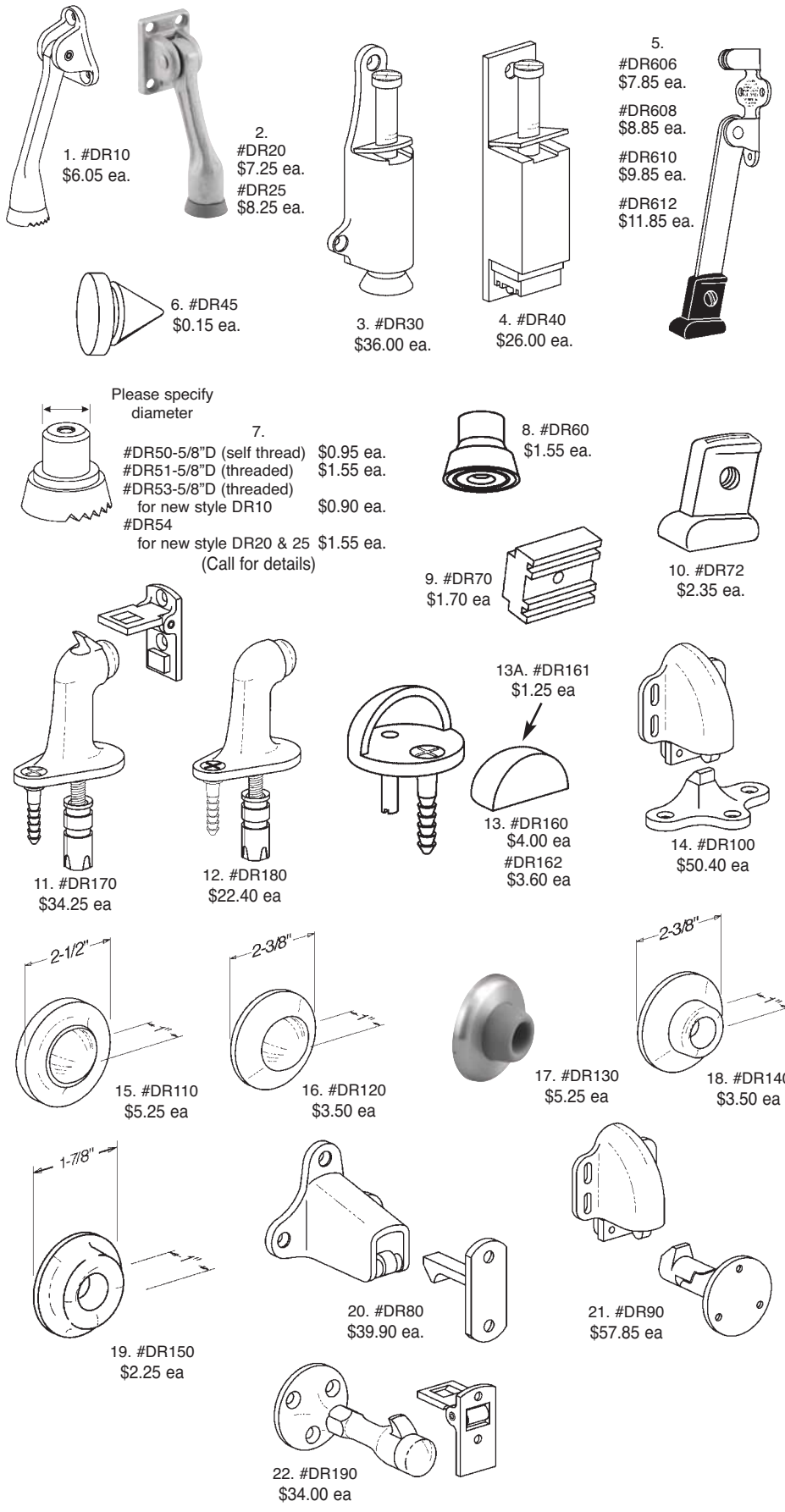

1. #DR10  
\$6.05 ea.

2. #DR20  
\$7.25 ea.  
#DR25  
\$8.25 ea.

3. #DR30  
\$36.00 ea.

4. #DR40  
\$26.00 ea.

5. #DR606  
\$7.85 ea.  
#DR608  
\$8.85 ea.  
#DR610  
\$9.85 ea.  
#DR612  
\$11.85 ea.

6. #DR45  
\$0.15 ea.

Please specify diameter

7. #DR50-5/8"D (self thread) \$0.95 ea.  
#DR51-5/8"D (threaded) \$1.55 ea.  
#DR53-5/8"D (threaded) for new style DR10 \$0.90 ea.  
#DR54 for new style DR20 & 25 \$1.55 ea.  
(Call for details)

8. #DR60  
\$1.55 ea.

9. #DR70  
\$1.70 ea.

10. #DR72  
\$2.35 ea.

11. #DR170  
\$34.25 ea.

12. #DR180  
\$22.40 ea.

13. #DR160 \$4.00 ea.  
#DR162 \$3.60 ea.

13A. #DR161 \$1.25 ea.

14. #DR100  
\$50.40 ea.

15. #DR110  
\$5.25 ea.

16. #DR120  
\$3.50 ea.

17. #DR130  
\$5.25 ea.

18. #DR140  
\$3.50 ea.

19. #DR150  
\$2.25 ea.

20. #DR80  
\$39.90 ea.

21. #DR90  
\$57.85 ea.

22. #DR190  
\$34.00 ea.

## KICK DOWN HOLDERS

Brass with Dull Chrome Finish

1. Cat. No. DR10 (4"L)

Cast Iron Painted Aluminum

2. Cat. No. DR20 (4"L)

Cat. No. DR25 (5"L)

## PLUNGER TYPE HOLDERS

3. Cat. No. DR30 (US26D Finish)

4. Cat. No. DR40 (Aluminum Finish)

## ADJUSTABLE / LEVER TYPE DOOR HOLDERS

5. Cat. No. DR606 (6"L)

(Brass or Zinc Finish)

Cat. No. DR608 (8"L)

(Zinc Finish only)

Cat. No. DR610 (10"L)

(Zinc Finish only)

Cat. No. DR612 (12"L)

(Zinc Finish only)

## DOOR SILENCER FOR METAL DOORS

6. Cat. No. DR45

## REPLACEMENT SHOES

7. FOR DR10-DR25

Cat. No. DR50, DR51, or DR53

8. FOR DR30—Cat. No. DR60

9. FOR DR40—Cat. No. DR70

10. FOR DR605—Cat. No. DR72

## FLOOR MOUNTED

11. Cat. No. DR170

12. Cat. No. DR180

13. Cat. No. DR160 without threshold

Cat. No. DR162 with threshold

Replacement Bumper

13A. Cat. No. DR161

14. Cat. No. DR100

## WALL BUMPERS

15. Cat. No. DR110 (Cast)

16. Cat. No. DR120 (Stamped)

17. Cat. No. DR130 (Cast)

18. Cat. No. DR140 (Stamped)

19. Cat. No. DR150 (Adhesive mt)

## WALL MOUNTED

20. Cat. No. DR80

21. Cat. No. DR90

22. Cat. No. DR190

**Centar Industries** INCORPORATED  
16313 WESTWOODS BUSINESS PARK, ELLISVILLE, MO 63021  
CALL TOLL FREE: 1-800-843-7878 • FAX 1-636-391-2336

MANY MORE VARIETIES  
AVAILABLE  
PLEASE CALL FOR DETAILS